

# Fuji Electric Accessories for 22mm Command Series Pilot Devices



AR9B290

Contact Blocks for Command Series 22mm Pilot Devices				
Part Number	Qty	Price	Contacts	Color
AR9B290	1	\$5.50	NO	Blue
AR9B291	1	\$5.50	NC	Red

Max 6 contacts for non-illuminated momentary devices. Max 4 for alternate action non-illuminated devices.

Max 5 contacts for illuminated momentary devices. Max 3 for alternate action illuminated devices.

\*Exceeding the maximum number of contacts could affect the mechanical durability of the operators.



AR9B291

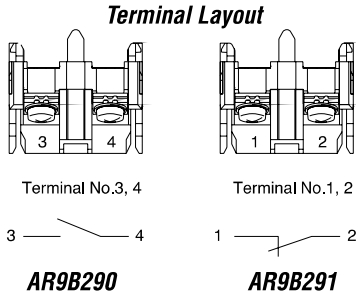

**Dimensions mm [in]**

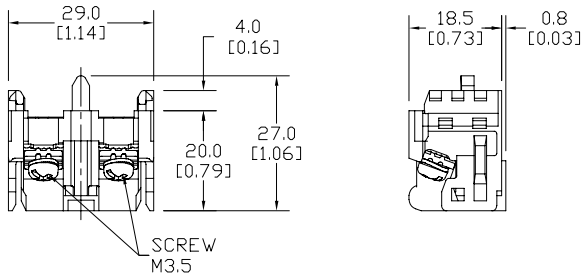

LED Bulbs for Command Series 22mm Pilot Devices								
Part Number	Color	Qty	Price	Use With	Lamp Voltage	Current Consumption	Power Consumption	Lamp Durability
APX510-24R	Red	2	\$13.50	AR22 / DR22 Series	24V AC/DC	12mA AC 11mA DC	0.8 W	30,000h
APX510-24G	Green	2	\$13.50					
APX510-24Y	Yellow	2	\$13.50					
APX510-24S	Blue	2	\$52.00					
APX510-24O	Orange	2	\$13.50					

\*Lamp base: Ba9s/13



APX510-24R

**Lamp Replacement**

Insert the tip of a small screwdriver into the slot between color knob and bezel.

Then pry knob up and remove.

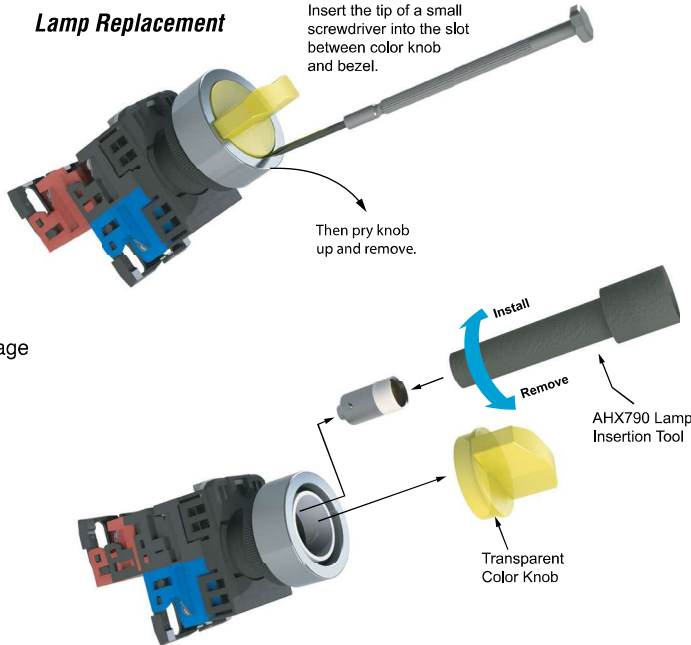

**Estimated durability for LED lamps**

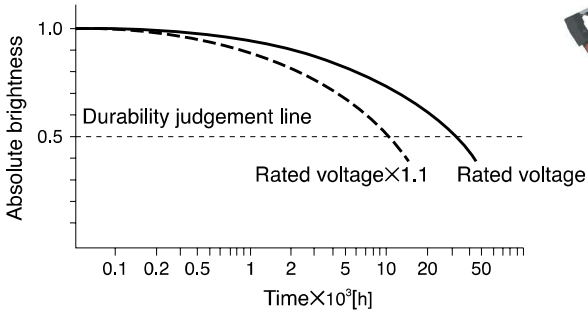

Notes: • Durability at Ta=25°C  
• Durability is affected by temperature, humidity, and voltage fluctuation.