

**PRESSURE PLATE**  
(MOVABLE)  
SECTION A-A

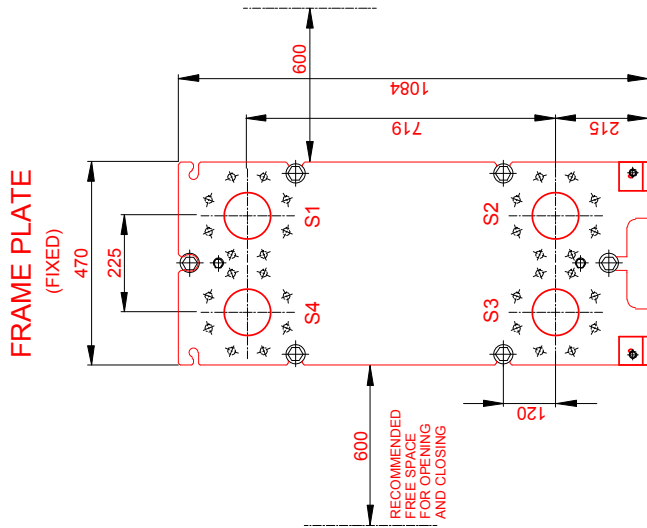

EN 1092-1 DN100 PN10  
UNLINED  
S1, S2, S3, S4

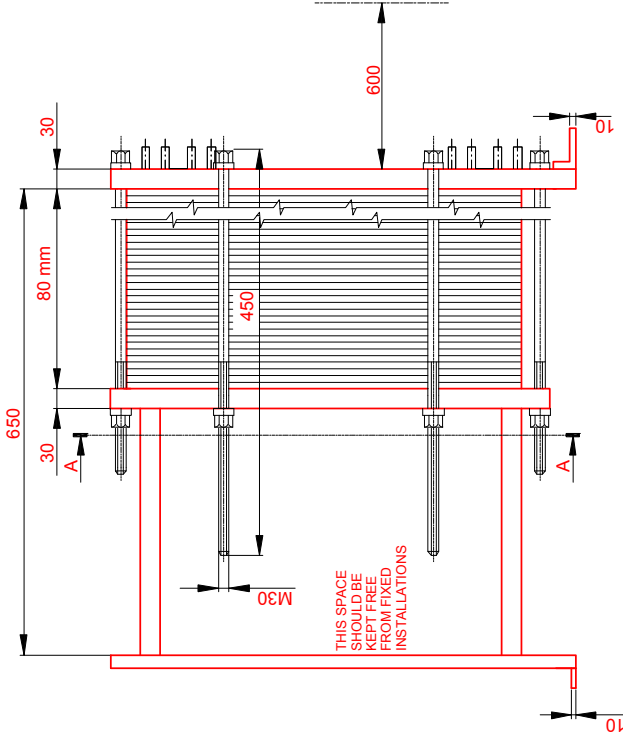
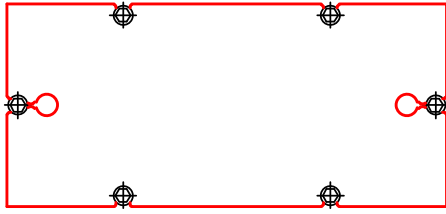
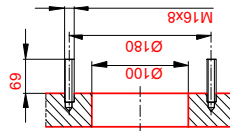

TOTAL LENGTH 885  
TOTAL WIDTH 470  
TOTAL HEIGHT 1084

FLOW RATE 9.780 kg/s  
19.47 kg/s

TEMP. 70.0 °C  
15.0 °C

OUTLET S2  
S4

F.D.G. 2  
2

MEDIA Water  
Water

PRESSURE DROP 31.47 kPa  
104.1 kPa

LIQUID VOL. 8.46 dm<sup>3</sup>  
9.46 dm<sup>3</sup>

Do not use this drawing for foundation bolting or piping layout.

ALL DIMENSIONS IN MILLIMETERS

REMARKS:	SIDE 1	SIDE 2
TEST PRESSURE	7.2 bar	7.2 bar
DESIGN PRESSURE	5 bar	5 bar
MAX TEMPERATURE	100 °C	100 °C
MIN TEMPERATURE	0 °C	0 °C
NETWEIGHT	293 kg	
WEIGHT WITH WATER	311 kg	

GASKET	NBRP Clip-on
PLATE MATERIAL	ALLOY 316
PLATE THICKNESS	0.50 mm
HEATING SURFACE	3.5 m <sup>2</sup>
PLATE GROUPING	1*8L/1*9L
HEAT LOAD	819 kW

SUPPLIER	REF.	ITEM NO.
AGENT / REF.		179764
CUSTOMER NAME / REF. NO.		
КРИСМЕТАЛ ООД		
SIGN.	RISK CATEGORY	
Slav Slavov	0	

PLATE HEAT EXCHANGER

# M10-MFM

PED



0000179764	
DATE	REV NO.
2017-12-07	0